



99x37

99x37

99x37

|                                      |                 |                 |                         |  |   |  |               |                 |
|--------------------------------------|-----------------|-----------------|-------------------------|--|---|--|---------------|-----------------|
| REVISIONS<br>NO. DATE DESCRIPTION BY | SURVEYOR'S SEAL | ENGINEER'S SEAL | PROJECT DATA            | PROJECT DATA<br>DATE: DEC 01, 2003<br>SCALE: 1/8"=1'<br>CHECKED BY: D.W.<br>DRAWN BY: P.D.P. | <b>LD&amp;D</b><br>LAND DESIGN & DEVELOPMENT, INC.<br>204 VINE STREET, SUITE 2<br>LOUISVILLE, KENTUCKY 40222<br>PHONE: (502) 639-5834 FAX: (502) 639-5834 | OWNER:<br><b>BROOKLEY PLACE</b><br>BROOKLEY PLACE, LLC<br>10717 BLACK WALNUT BLVD.<br>LOUISVILLE, KENTUCKY 40229<br>(502) 639-5834 | JOB NO. 02008 | SHEET 2<br>OF 3 |
|                                      |                 |                 | FLOOR PLAN - BUILDING 1 |  |   |  |               |                 |

Document No. 1000027611  
 Logged On 12/01/03 4:50 PM  
 Reported On 12/01/03 4:50 PM  
 For Project 1000027611  
 Transfer To  
 County 00000  
 Supply Chain 00000

99x37  
 1712

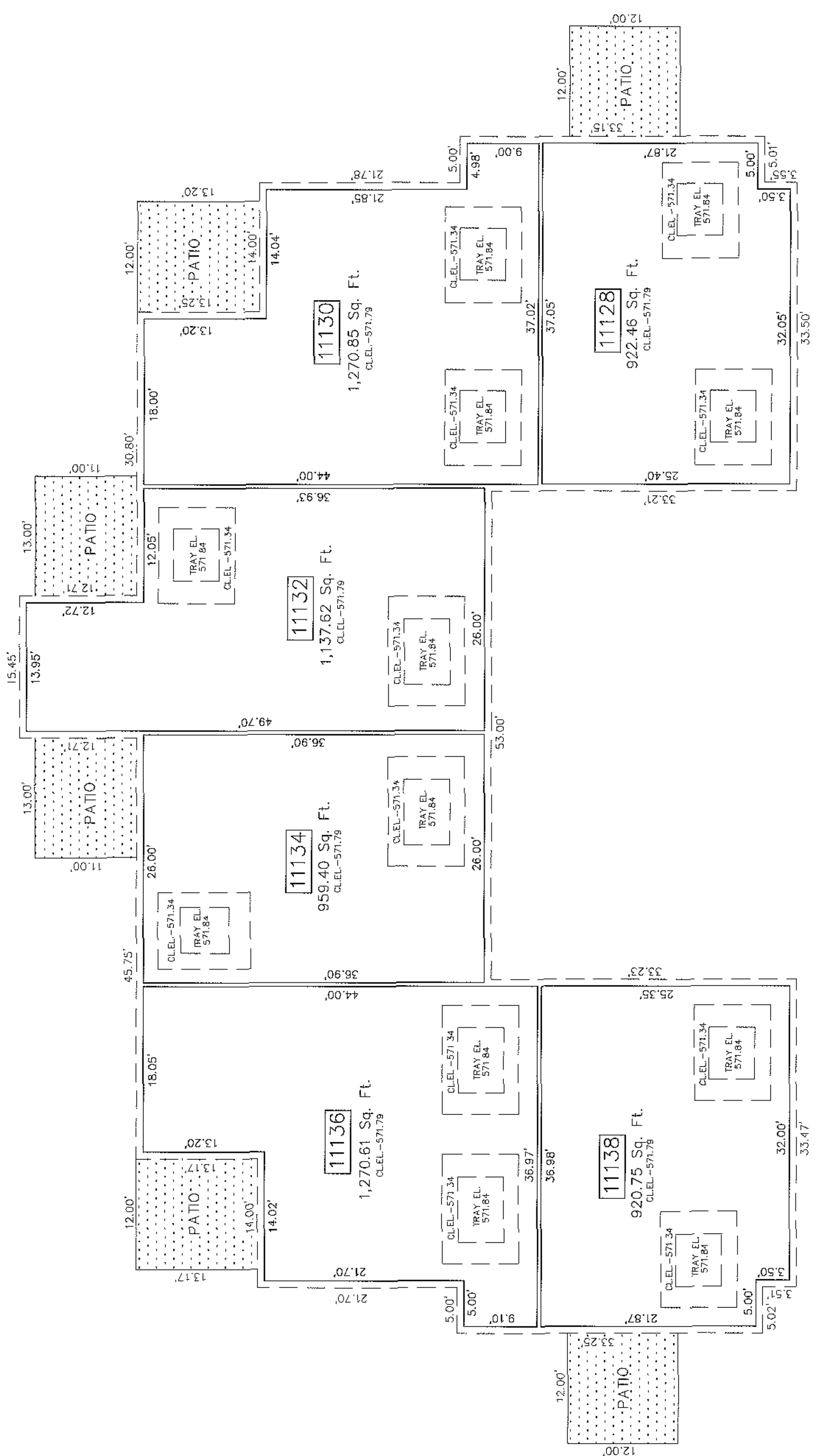

**BUILDING 1**  
 FINISH FLOOR ELEV. = 563.49

- LEGEND**
- C.E.L. - CEILING ELEVATION
  - TRAY\_EL - TRAY ELEVATION
  - [Dotted Pattern] - LIMITED COMMON SPACE
  - [Dashed Line] - LIMITS OF OWNERSHIP
  - [Dash-dot Line] - LIMITS OF COMMON SPACE (BUILDING EXTERIOR)

99x37

99 X 38

99 X 38

|                                      |   |   |               |
|--------------------------------------|---|---|---------------|
| REVISIONS<br>NO. DATE DESCRIPTION BY | PROJECT DATA<br>FILE NAME: bldg2.dwg<br>SCALE: 1/8"=1'<br>DATE: DEC. 01, 2003<br>CHECKED BY: D.W.<br>DRAWN BY: P.O.P. | <b>L&amp;D</b><br>LAND DESIGN & DEVELOPMENT, INC.<br>ENGINEERING • LAND ARCHITECTURE • LANDSCAPE ARCHITECTURE<br>10717 BLACK WALNUT BLVD., SUITE 200<br>LOUISVILLE, KENTUCKY 40229<br>PHONE: (502) 494-9574 FAX: (502) 494-9575 | JOB NO. 02006 |
|                                      |   |   | SHEET 3 OF 3  |

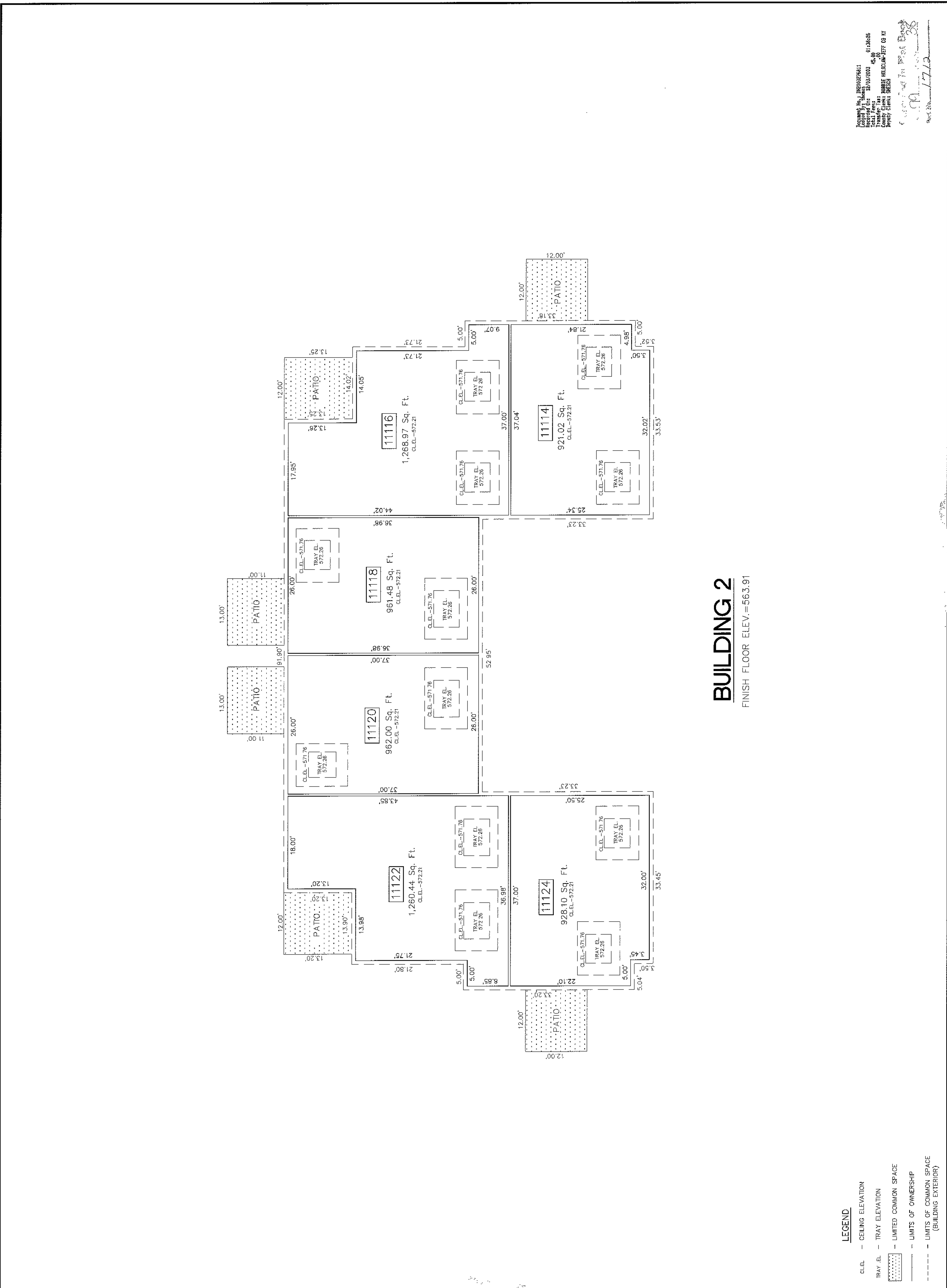

Accounting No.: 2800028141  
 Building No.: 111  
 Total Fees: 45,000  
 Total Cost: 1,117,000  
 Property: 111  
 County: Shelby  
 City: Memphis  
 State: TN  
 Date: 12/1/03  
 By: [Signature]

99 X 38

99 X 38

11/17/03 10:54:00 AM